

Thank you for your interest in our yachts. We are pleased to present you the following yacht:

Lagoon 46 (2024)

1050000,- Euro



Boat details

Manufacturer: Lagoon
Model: Lagoon 46
Year of build: 2024
Length: 13,74 m
Price: 1050000,-Euro

Cabins: 4
Berth: 6
Heads: 4
Fuel: Diesel
Draught: 1,35 m

Condition: existing yacht (new)
Type: Multihull
Hull material : GFK (Fiberglas)
Drive: Sail-Drive
Width : 8,18 m

Located :
Boat-ID: 20231-25



Lagoon 46 (2024)

1050000,- Euro

Description :

New LAGOON 46, 4-cabin charter version with 2 additional bow cabins, delivery APRIL 2024.
Fully equipped with air conditioning, generator, watermaker and much more.
Please have a look at the extensive equipment list.

General Information

Engine 1: YANMAR 4JH57

Typ: In board engine

Fuel: Diesel

Engine Power: 57 PS

Drive: Sail-Drive

Length over all: 14 m

Width: 8,18 m

Max. bridge clearance: 23,22 m

Draught: 1,35 m

Single berths: 2

Double berths: 4

Type: Multihull

Flag: Germany

Engine 2: YANMAR 4JH57

Typ: In board engine

Fuel: Diesel

Engine Power: 57 PS

Drive: Sail-Drive

Net. weight: 15.773 kg

Displacement:

Fuel capacity: 2x 519 l

Fresh water capacity: 2x 299 l

Cabins: 4

Heads: 4

Tops/Hoods

Bimini Top

Lazy Bag

Lazy Jacks

Electric equipment

Shorepower connection

Inverter (INVERTER 12 / 220V 50HZ - 2000VA)

Electrical bilge pump

Generator (PRE-FITTING ONAN GENSET 11Kva 220V / 50Hz)

Solar

Electronic equipment

Echolot / Depth sounder

Log/Speedometer

Wind speed / Wind direction

Daughter-device

Radar

Chartplotter

Autopilot

Radio

Compass

GPS

VHF

Cockpit-speaker



Interior

Oven
Manuel bilge pumpe
Air condition
Electrical toilette
Heating
TV
Hot water
Fridge
Freezer
Watermaker
Battery charger

Deck equipment

Cockpit shower
Mounting for outboard engine
Davits
Radar reflector
Dinghy
Life raft
Cockpit pillows
Cockpit table
Bath ladder

Takelage

Steering wheel
Electrical windlass 50.2 STAEH

Sails

Full battend mainsail
Furling genua

Manufacturer's description

The Lagoon 46 is ideal for long cruises. It is the first catamaran of its size to offer a flybridge as dedicated to easy handling as it is to relaxation, with its convertible sundecks and well-equipped helm station.



EQUIPMENT LIST

LAGOON 46

VERSION 4 CABINS, 4 HEADS, 2 x 57 HP (Yanmar 4JH57)

STANDARD INTERIOR WOOD IN ALPI SAND OAK WITH DARK OAK FLOOR - 4-CABINS

BOISERIE INTÉRIEURE STANDARD EN ALPI SAND OAK AVEC PLANCHER DARK OAK - 4 CABINES

BERTH IN PORT BOW COMPARTMENT - ALPI SAND OAK

BERTH IN STARBOARD BOW COMPARTMENT - ALPI SAND OAK

COMFORT EQUIPMENT 4 CABINS - ALPI SAND OAK

1 battery charger 60Amp - Electric circuit - 3 additional service batteries 140Amp + battery controller - Monitoring display (Navicolor) - USB sockets in the cabins (x4) - Electrical manoeuvre winch 50.2 STAEH - S/steel dinghy hoist system & manual winch - Pulpits with wooden seats - Helm seat cushions Dark Grey - Extra fridge 90L and freezer 65L at starboard (drawers) - Indirect lighting in cabins and salon - Port hole and window in aft cabins with blind - Fusion APOLLO MS-RA 670 + 6 loudspeakers in salon, cockpit and fly - Freshwater dock inlet - Deck wash pump sea water / fresh water - Electric toilets Quiet-Flush - Fans in salon and cabins - Sea water electrical pump, with dedicated tap - Fridge 80L in aft cockpit - Deck courtesy lights in cockpit, transoms and flybridge - Windlass remote control at helm station with chain counte

STANDARD UPHOLSTERY DUNE (salon & settees) - 4-CABIN VERSION

AFT COCKPIT CUSHIONS - DARK GREY

FORWARD COCKPIT CUSHIONS - DARK GREY

SUNBATH CUSHIONS WITH LIFTING BACKREST FOR FLYBRIDGE - DARK GREY

ALUMINIUM CANOE BOOM + GRAPHITE COVER

EXTRA FOR DACRON SQUARE TOP MAINSAIL IN LIEU OF STANDARD

ADDITIONAL SWIM LADDER WITH 2nd HOT COCKPIT SHOWER AT STARBOARD SIDE

EXTRA FOR ELECTRICAL ASSISTANCE (Flatwinder) FOR DINGHY HOIST SYSTEM

SINK IN THE COCKPIT - ALPI SAND OAK

EXTRA FOR SLIDING COCKPIT BENCH

LARGE FOLDABLE WOODEN TABLE WITH COVER - GRAPHITE

COCKPIT SIDES AND AFT SUN CANVAS - GRAPHITE

FLYBRIDGE COMPOSITE BIMINI WITH WINDSCREEN - GRAPHITE



EQUIPMENT LIST

ENGINES 2 x 57 HP (Yanmar 4JH57)
PRE-FITTING GENSET 11Kva 220V / 50Hz
INVERTER 12 / 220V 50HZ - 2000VA
WATERMAKER 100L (26US Gal)/H 12/220V
DOUBLE BERTH IN SALON DUNE
LARGE SLIDING FORWARD ROOF WINDOW
EXTRA FOR FREEZER 90 L & FRIDGE 155 L
EXTRA FOR FORCE 10 STAINLESS STEEL OVEN - ALPI SAND OAK
EXTRA FOR FORCE 10 4 BURNER COOKING TABLE - ALPI SAND OAK
SALON CURTAINS
ROLLER BLINDS IN THE CABINS - 4 CABIN VERSION
STORES ROLLER DANS LES CABINES - VERSION 4 CABINES
REVERSE CYCLE WEBASTO AIR CONDITIONING 220V - 4 CABIN VERSION
2023 RAYMARINE NAVIGATION PACK

- Multifunction i70s display at helm station
 - P70s autopilot + ACU-400 actuator control unit + Gyro
 - Speed/Depth/Temp Transducer
 - Wind transducer
 - RAY90 VHF
 - AIS700 transceiver
 - Axiom Pro 16" display at helm station
 - Card included
 - Multifunction i70s display at helm station
 - P70s autopilot + ACU-400 actuator control unit + Gyro
 - Speed/Depth/Temp Transducer
 - Wind transducer
 - RAY90 VHF
 - AIS700 transceiver
 - Axiom Pro 16" display at helm station
 - Card included
- Rest of the World Navionics card

RAYMARINE AXIOM + 12" DISPLAY AT NAV. STATION - ALPI SAND OAK
RAYMARINE AUTOPILOT REMOTE
RAYMARINE REALVISION SOUNDER
RAYMARINE CAMERAS
BOSE FREESPACE 3 SPEAKER PACK IN THE SALON
PRE-FITTING FOR TV 220V IN THE SALON
ENGLISH OWNER'S MANUAL

The Company offers the details of this vessel in good faith but cannot guarantee or warrant the accuracy of this information nor warrant the condition of the vessel. A buyer should instruct his agents, or his surveyors, to investigate such details as the buyer desires validated. This vessel is offered subject to prior sale, price change, or withdrawal without notice



DISCLOSER: Die Firma stellt alle Angaben zu diesem Schiff/Boot in gutem Glauben bereit

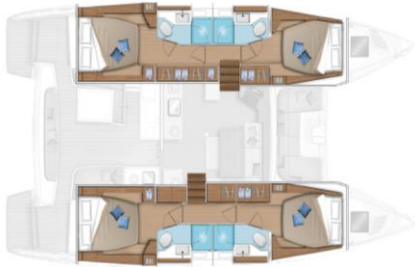

Contact:

Yachtbüro Grucza - Hamburg

Email: info@yachtbuero-grucza.de

Mobile: +49 157 8509 9857

You will find more yachts here:

www.yachtbuero-grucza.de





Thanks to our many years of experience in various areas relating to yachts, both as yacht owners (experienced blue water sailors) and in the successful development and management of a large, international charter company, we can provide you with the best advice on the topics of yacht purchase, yacht sale and yacht investment/charter investment. We will be happy to answer your questions at any time.

Yours,

**Jürgen
Grucza**

Contact:

Yachtbüro Grucza - Hamburg

Email: info@yachtbuero-grucza.de

Mobile: +49 157 8509 9857

You will find more yachts here:

www.yachtbuero-grucza.de

